

How to “Sign in to Join” a Zoom meeting

Due to enhanced security measures, your child may be prompted to “Sign in to Join” their class Zoom meeting. Students should continue to access their class Zoom link by going to their classroom teacher’s Google Classroom and clicking the Zoom link.

After clicking the Zoom link, they may see the below prompt to “Sign in to Join.”

1. Students should select, “Sign in to Join.”

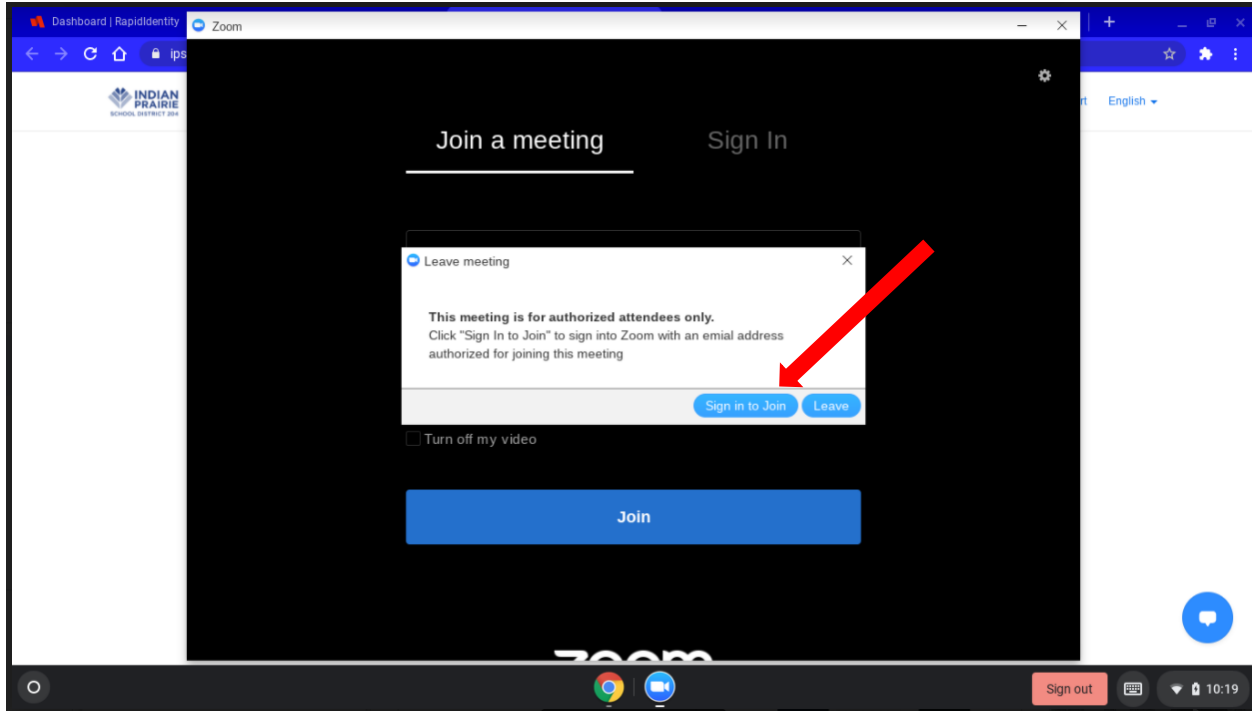

2. Select “Sign in with Google.”

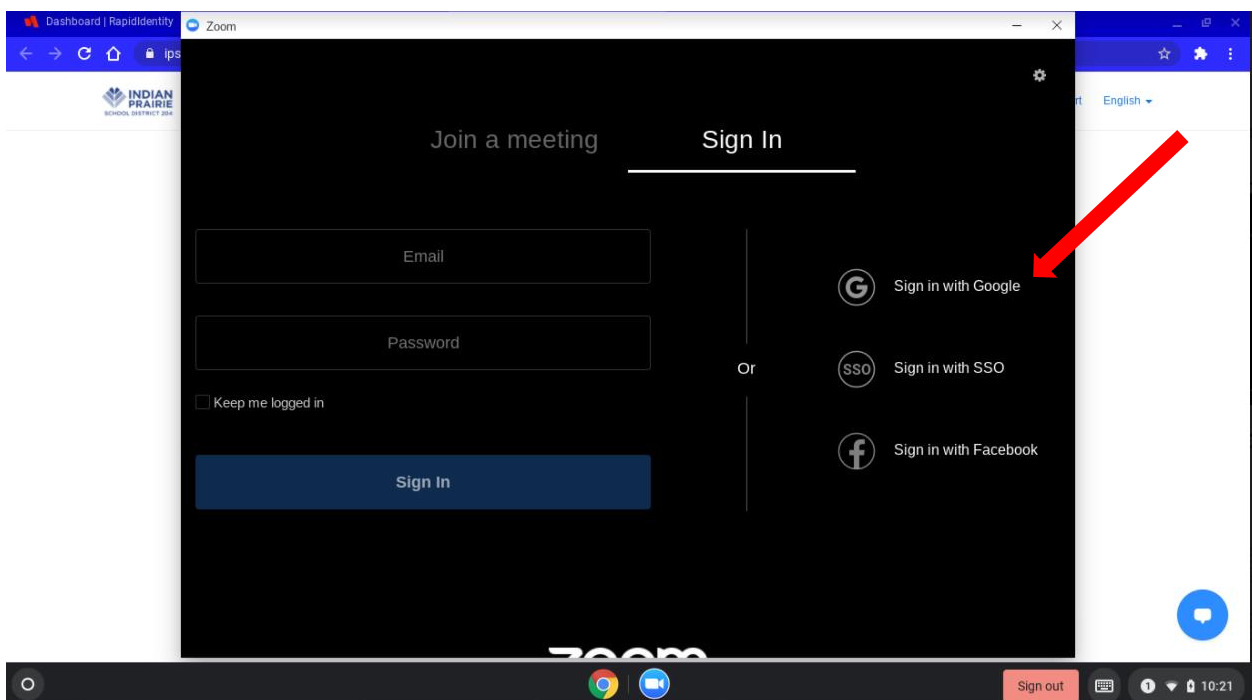

3. **Students will be prompted to enter their email address, then select “Next.”**

- a. Students’ email addresses are their Student Username with @k12.ipspd.org as the domain. For example, student “John Smith” with student ID number 0001234 would have the Username of johnsmi1234 and an email address of johnsmi1234@k12.ipspd.org.

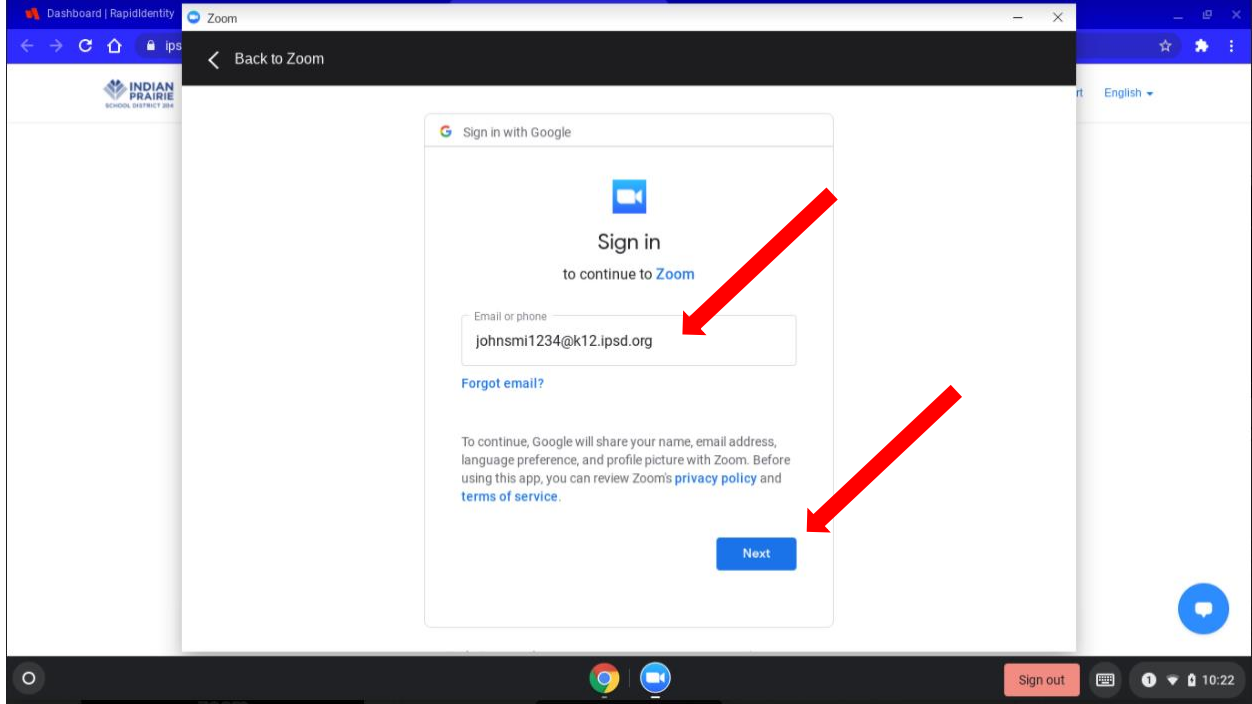

4. **Enter District Username (e.g. johnsmi1234). Then press “Go.”**

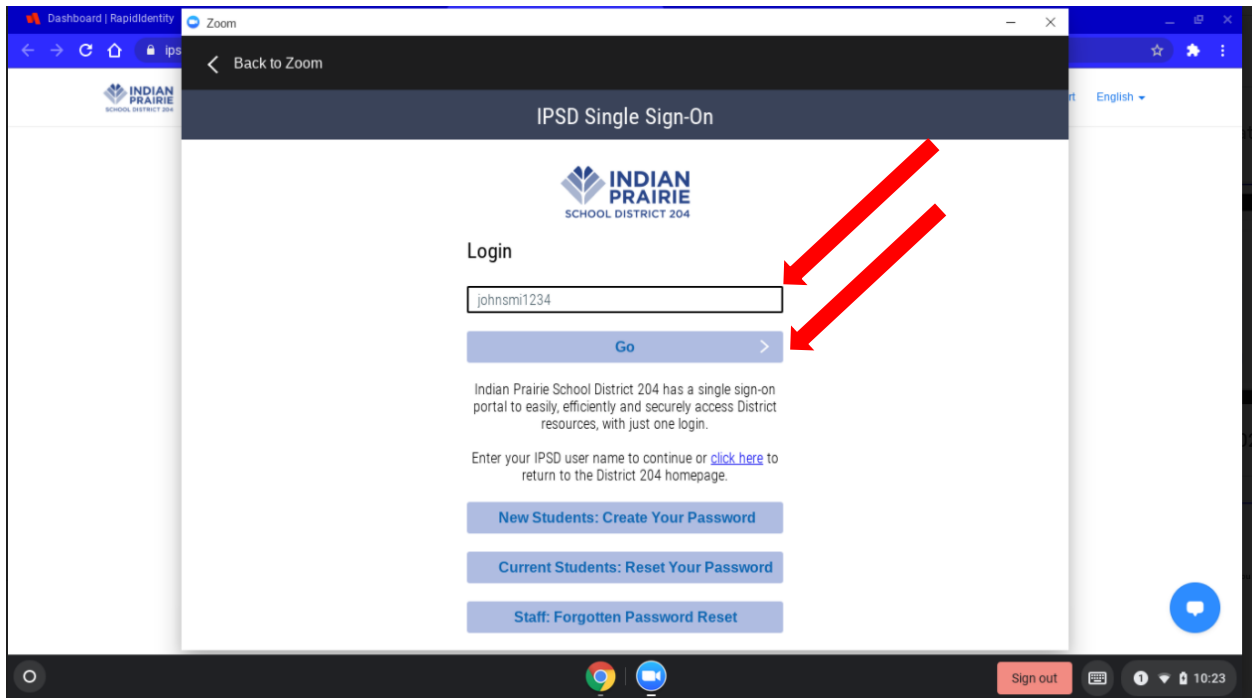

5. Enter District Password. Press “Go.”

- a. If your child uses a picture password, they will be prompted to choose their pictures.

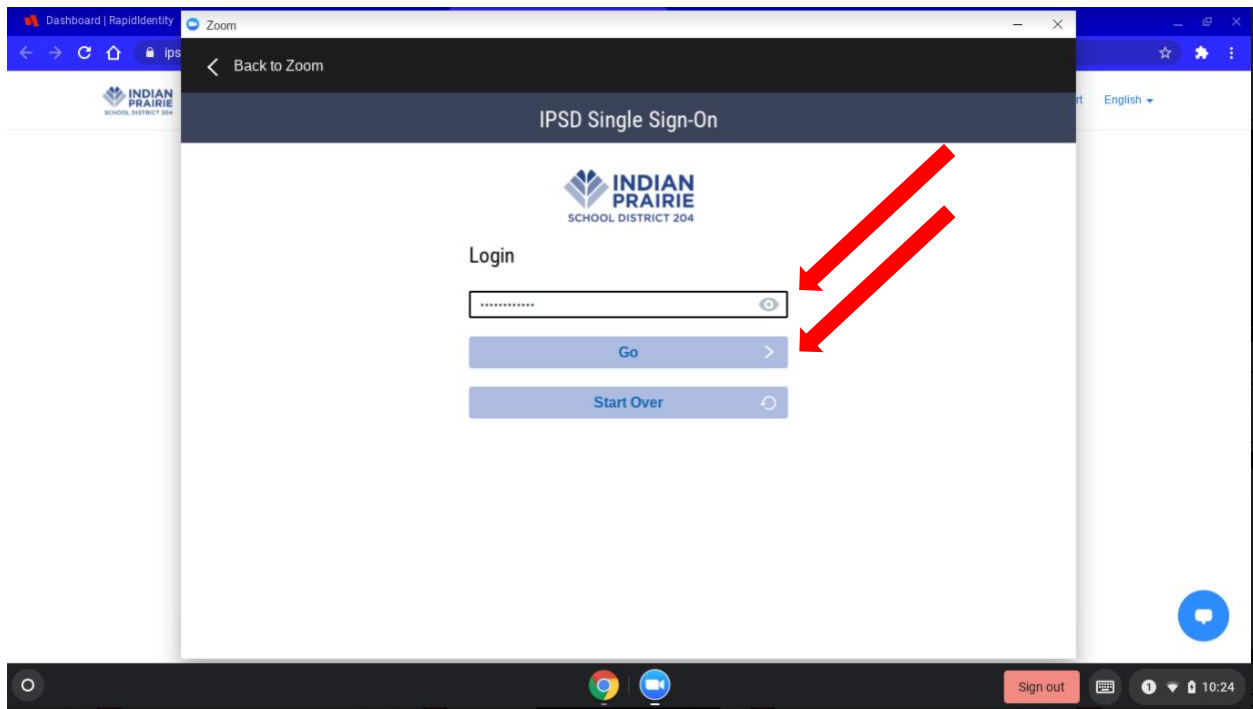

6. After pressing “Go,” your child should be connected to their Zoom meeting, and see the below message as their teacher individually admits students into class.

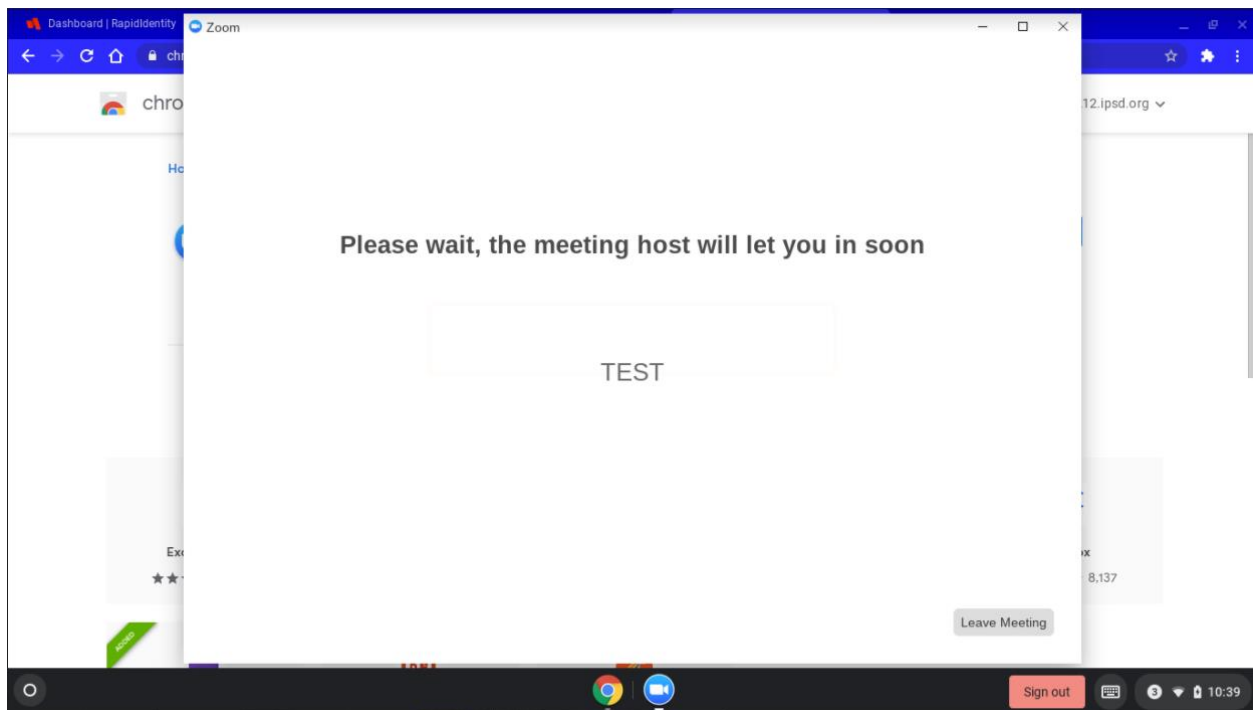

Note:

- Students may not have to complete the above steps the next time they select a Zoom link (it may connect automatically after completing this process once).
- Please reach out to your child’s classroom teacher, Ms. Happy (Elizabeth_happy@ipsd.org) or the main office 630-428-6700, if your child is having difficulty joining their Zoom meeting.